

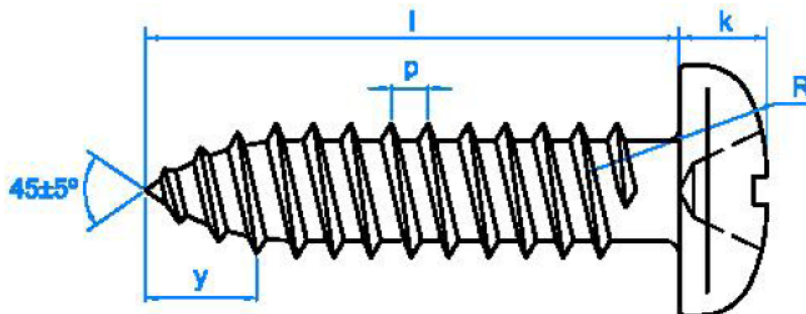

Familia 66502 – Tornillo rosca chapa cabeza alomada zincado D-7981 Philips

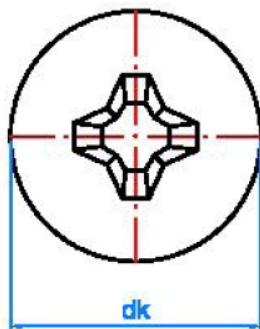

Código	Denominación Artículo	Udes/Caja
159887	TLLO R/CH. C/ALOM D-7981 2,9X6,5 ZINC(24-U)	30
159894	TLLO R/CH. C/ALOM D-7981 2,9X9,5 ZINC(22-U)	30
159900	TLLO R/CH. C/ALOM D-7981 2,9X13 ZINC(20-U)	30
159082	TLLO R/CH. C/ALOM D-7981 3,5X9,5 ZINC(20-U)	30
159917	TLLO R/CH. C/ALOM D-7981 3,5X16 ZINC(16-U)	30
159924	TLLO R/CH. C/ALOM D-7981 3,5X19 ZINC(16-U)	30
159931	TLLO R/CH. C/ALOM D-7981 3,5X25 ZINC(14-U)	30
159099	TLLO R/CH. C/ALOM D-7981 3,9X13 ZINC(16-U)	30
159948	TLLO R/CH. C/ALOM D-7981 3,9X19 ZINC(13-U)	30
159955	TLLO R/CH. C/ALOM D-7981 3,9X25 ZINC(12-U)	30
159962	TLLO R/CH. C/ALOM D-7981 3,9X32 ZINC(10-U)	30
159979	TLLO R/CH. C/ALOM D-7981 4,2X16 ZINC(12-U)	30
159986	TLLO R/CH. C/ALOM D-7981 4,2X25 ZINC(10-U)	30
159993	TLLO R/CH. C/ALOM D-7981 4,2X32 ZINC(8-U)	30



Código		ST 2.9	ST 3.5	ST 3.9	ST 4.2	ST 4.8	ST 5.5	ST 6.3
dk: diámetro cabeza	[mm]	5.45	6.7	7.3	8.0	9.4	10.6	12.3
k: espesor cabeza	[mm]	2.2	2.6	2.8	3.05	3.55	3.95	4.55
Mortaja Phillips nº		1	2	2	2	2	3	3
R: radio cabeza	[mm]	4.4	5.4	5.8	6.2	7.2	8.2	9.5
D: diámetro exterior rosca	[mm]	2.90	3.53	3.90	4.22	4.80	5.46	6.25
d: diámetro interior rosca	[mm]	2.18	2.64	2.92	3.10	3.58	4.17	4.88
p: paso rosca	[mm]	1.1	1.3	1.3	1.4	1.6	1.8	1.8
y: longitud de punta ≤	[mm]	2.6	3.2	3.5	3.7	4.3	5	6
l: longitudes	[mm]	6 -- 25	6 -- 38	6 -- 50	9 -- 90	9 -- 140	13-- 120	13-- 120
l _G : longitud máxima de rosca	[mm]	--	--	--	--	90	90	90
Código punta de instalación (punta Phillips)		PUPHC01 PUPHL01	PUPHC02 PUPHL02	PUPHC02 PUPHL02	PUPHC02 PUPHL02	PUPHC02 PUPHL02	PUPHC03 PUPHL03	PUPHC03 PUPHL03

